

Come and see!

Using the information you have told us, alongside technical studies and surveys that have taken place, we have more detailed proposals for buildings and spaces that we would like to show you.

At the exhibition you will be able to see more information about:

- Plans for improvements across the wider estate area.
- How cars, people and bicycles will access the estate and arrangements for parking.
- What new buildings could look like and how tall they might be.
- The proposals for new areas of open space and play space.

Multimedia competition entries will be exhibited and winner announced!

Our primary objectives:

- New homes will be for council rent
- Existing residents of Lennox Estate will be given priority for new homes
- No overall loss of green space
- New play spaces and sports facilities
- Controlled parking and free permits for existing estate residents
- Improved walking and cycling routes
- No loss of community or education facilities

Residents exhibition!

Time: 4 - 8pm

Date: Tuesday 26th November

Location: Paddock School

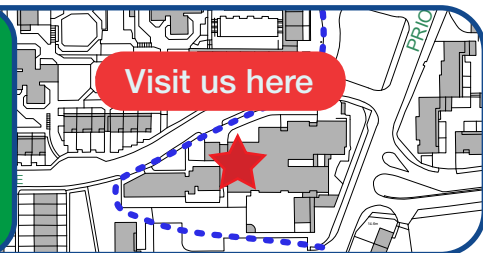

Come to the event and tell us your views!

We are available for you by email:
developmentteam@richmondandwandsworth.gov.uk

Lennox Estate News

Newsletter 2

Welcome to the latest edition of the Lennox Estate newsletter!

Over the last six months we have been working hard on plans for the northern area of the Lennox Estate, in and around Arabella Drive. Your feedback has helped us develop designs for the new buildings and spaces.

Therefore, you are warmly invited to view our updates and voice your thoughts.



Keep up to date via our website here:



www.lennox-homesforwandsworth.co.uk/

Please join us for:

Residents exhibition

Time: 4 - 8pm

Date: Tuesday 26th November

Location: Paddock school



What you told us!

Last time, you told us how important **green spaces** are, how you wanted the new buildings to be **sensitive to their surroundings**, and that the organisation and management of **parking** is important to you.

When we visited this summer, we held activities for young residents that involved drawing and games! Here's what they said about the open spaces and play spaces on Lennox Estate:

- They wanted to see more **swings, seesaws** and **slides**.
- That more **trees, plants and flowers** are also important to younger residents.
- You said you would like a **community garden** and **children's gardening club**.
- They like to use the **games court** for a range of activities including **cycling, football** and **basketball**.
- They like a mixture of **open spaces for sports** and quite spaces with benches.

We heard that you were worried about the removal of green space. Our new design keeps the green space where it is and adds a new pocket park!

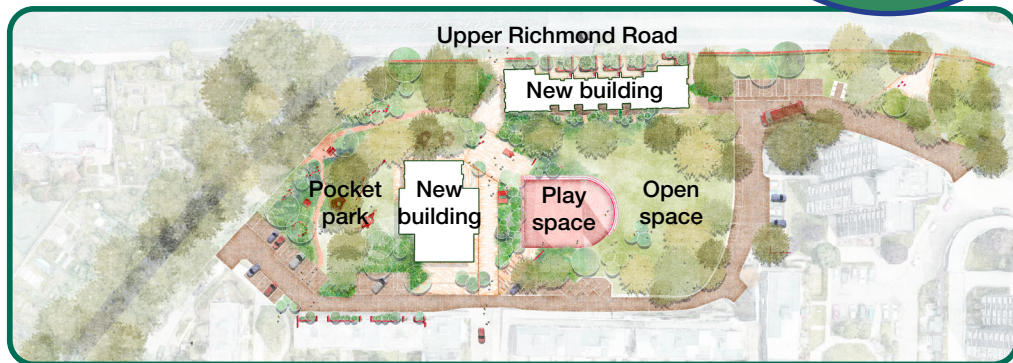

Update!

Our Multimedia competition deadline has been extended!

You can submit your entry up until the day of the event

See website for more details.

Whats next ?

We are here

Summer 2024

We held Summer events for young people and a multi media competition.

The project team have been working on more detailed designs for new buildings and open spaces.

Autumn 2024

Exhibition to show you the latest designs for new buildings and spaces. We will also display all the entries for the art competition and announce the winners!

Winter 2024/25

Review of resident feedback and further development of plans.

Beverley Brook

Did you know that the Lennox Estate has its own brook? Beverley Brook runs along the Northwestern edge of Lennox Estate and is an important ecosystem in the area. It is a vital habitat for a range of species of plants and animals.

The design team for the Lennox Estate project have been exploring how we can help educate residents about the brook and improve views of the brook from Lennox Estate!

